



MODEL:EN-RJ45-POE

IP Camera Surge protector Support POE :IEEE 802.3af
General Specifications

INTRODUCE

Surge is high voltage Transient generate by strike of lightning, hi- power mechanical it's damage to electronic equipment it's effect to cost The cost of maintenance is very expensive

Engicon (Thailand) Co.,Ltd.. Has seen the impact of those problems and we provide a Surge protection for protect product and system from those even.



IEEE 802.3af

	Ethernet RJ-45 Connector PIN Number							
Source Voltage	1	2	3	4	5	6	7	8
48V DC Protected	RX, DC+	RX, DC+	TX, DC-	Spare	Spare	TX, DC-	Spare	Spare

SPECIFICATION

- Power over ethernet (POE) standard IEEE802.3af
- Minimum discharge surge current : 5kA.
- Maximum discharge surge current : 10kA.
- Limited Voltage : 60V
- Data transmission rate Vs : 100Mbps
- Insert loss Ae : 0.2dB
- Compact size and easy to install

ENVIRONMENT

Operation T/H 0 to 60 °C / 20%RH to 80%RH

Storage T/H -30 to 70 °C / 10%RH to 90%RH

DIMENSION AND WEIGHT

W=25, L=67, D=25 Unit (mm)

Weight : 143 g





MODEL:EN-BNC-RG

Video BNC for Analog camera surge protection
General Specifications

INTRODUCE

Surge is high voltage Transient generate by strike of lightning, hi- power mechanical it's damage to electronic equipment it's effect to cost The cost of maintenance is very expensive

Engicon (Thailand) Co.,Ltd.. Has seen the impact of those problems and we provide a Surge protection for protect product and system from those even.



SPECIFICATION

- Respond time < 0.5ns
- Video Impedance : 75 Ohm
- Maximum discharge surge current : 10kA.
- Interface type : input : bnc
- Maximum operate voltage: 5.5V
- Bandwidth: 0-10Mhz.
- Intersection Loss < 2dB
- Flow capacity, Fast respond
- Use multi-level Protection circuit
- Low residual voltage
- Special treatment to avoid signal interface
- Compact size and easy to install
- Connector male&female

ENVIRONMENT

Operation T/H 0 to 80 °C / 20%RH to 80%RH

Storage T/H -30 to 90 °C / 10%RH to 90%RH

DIMENSION AND WEIGHT

W=25, L=51, D=25 Unit (mm)

Weight : 50 g



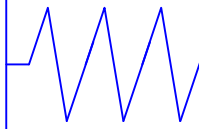

MODEL:EN-RS485-DATA

Data Device RS-485 surge protection
General Specifications

INTRODUCE

Surge is high voltage Transient generate by strike of lightning, hi- power mechanical it's damage to electronic equipment it's effect to cost The cost of maintenance is very expensive

Engicon (Thailand) Co.,Ltd.. Has seen the impact of those problems and we provide a Surge protection for protect product and system from those even.



SPECIFICATION

Nominal voltage VN: 12V

Most greatly continually control voltage UC: 15V

Nominal discharging current(8/20) IN : 10kA

Protection rank UP : 80V

Earth way: Earths directly through the segment

Insertion Loss Ae: 0.5db

Data transmission speed: 2Mbps

Port connection mode: terminal strip for twisted pair

External dimensions: 50 mm. x 25 mm. x 25 mm.

Operating temperature scope: - 40°C to + 70°C

ENVIRONMENT

Operation T/H 0 to 80 °C / 20%RH to 80%RH

Storage T/H -30 to 90 °C / 10%RH to 90%RH

DIMENSION AND WEIGHT

W=25, L=48, D=25 Unit (mm)

Weight : 75 g





MODEL:EN-PWR-10K

Power surge protection
General Specifications

INTRODUCE

Surge is high voltage Transient generate by strike of lightning, hi- power mechanical it's damage to electronic equipment it's effect to cost The cost of maintenance is very expensive

Engicon (Thailand) Co.,Ltd.. Has seen the impact of those problems and we provide a Surge protection for protect product and system from those even.



SPECIFICATION

- Discharge voltage: 220V
- Limiting voltage: 1000V
- Max discharge current I_{max}:10KA
- Response time T_a: 25ns
- Shell protection level: IP20
- Shell material: Aluminum

ENVIRONMENT

Operation T/H 0 to 80 °C / 20%RH to 80%RH

Storage T/H -30 to 90 °C / 10%RH to 90%RH

DIMENSION AND WEIGHT

W=25, L=80, D=25 Unit (mm)

Weight : 90 g





MODEL :LY1-C40

Surge Power 40KA
General Specifications

INTRODUCE

Surge is high voltage Transient generate by strike of lightning, hi- power mechanical it's damage to electronic equipment it's effect to cost The cost of maintenance is very expensive

Engicon (Thailand) Co.,Ltd.. Has seen the impact of those problems and we provide a Surge protection for protect product and system from those even.



SPECIFICATION

- Rate operation voltage : 220 Vac 50-60 Hz.
- Maximum operation voltage :275V
- Voltage level up : $\leq 1.2KV$
- Normal discharge current (8/20uS) : 20kA
- Maximum discharge current (8/20uS) : 40kA
- Test standard GB18802,IEC61643-1
- Respond time : $\leq 25ns$
- Fuse or switch : 32A

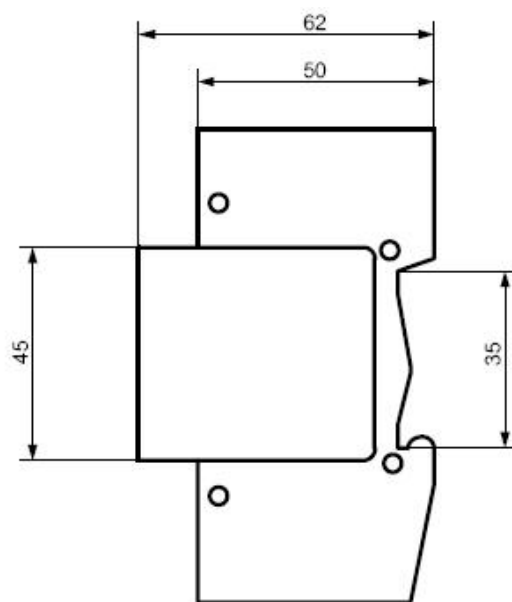

ENVIRONMENT

Operation T/H 0 to 85 °C / 20%RH to 80%RH

Storage T/H -30 to 90 °C / 10%RH to 90%RH

DIMENSION AND WEIGHT

W=35, L=82, H=62 Unit (mm)

Weight : 200 g

